

## CUSHY FOOT

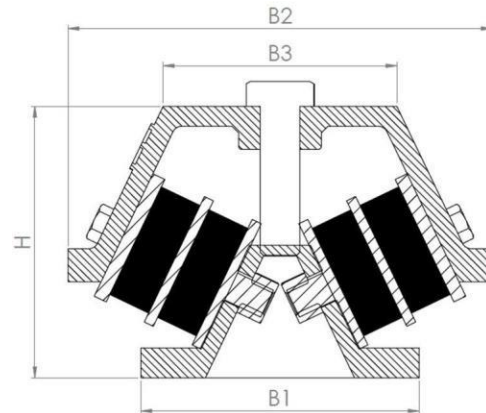
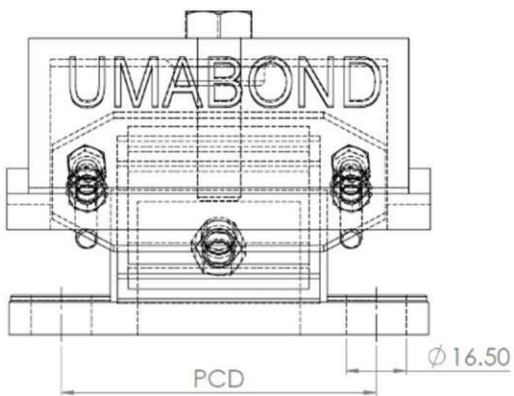

PRODUCT NAME	DIMENSIONS (in mm)			TOP HOLE STUD SIZE (in mm)	HOLE CENTRE PCD (in mm)	STATIC LOAD CAPACITY (kg)
	L	B2	H			
UMA-CF-A1	115	125	72	12	80	125
UMA-CF-A2	115	125	75	12	80	200
UMA-CF-B1	215	188	105	16	165	500
UMA-CF-B2	215	188	105	16	165	750
UMA-CF-B3	215	188	105	16	165	1250
UMA-CF-B4	215	188	105	16	165	1550

- It consists of two sandwich mounts in casting body to prevent against oil and mechanical damage and achieve high lateral stability.
- UMA-CF series is specially designed for machines that require vibration damping in both compression and shear.
- Load capacity mentioned is considered with Factor of Safety = Capacity/Demand = 1.8.

## CUSHY FOOT

- UMABOND Cushy Foot Mounts can also be anchored to the ground for machines with highly unbalanced forces. In case if they cannot be fastened, they can be located by Rubber friction pads.
- These mounts are designed to provide suitability of varied industrial application and well-built construction support providing longer durability.
- UMABOND Cushy Feet are available in two models both have two variants.
- Below given is the technical details for the polymer used ;

### CF-A1 / CF-B1 Series

Polymer	Natural
Temperature Range	-51° C to 80° C
Tensile Strength Range	9 to 11 Mpa
Elongation (Max %)	200%
Hardness	60 – 65 Shore A
Adhesive to Metals	Excellent
Aging Weather	Poor (Sunlight)
Resilience	Excellent (Rebound)
Compression Set	Excellent
Abrasion Resistance	Excellent
Tear Resistance	Excellent
Solvent Resistance	Poor
Oil Resistance	Poor

### CF-A2 / CF-B2 Series

Polymer	Natural
Temperature Range	-51° C to 80° C
Tensile Strength Range	16 to 18 Mpa
Elongation (Max %)	150%
Hardness	65 – 70 Shore A
Adhesive to Metals	Excellent
Aging Weather	Poor (Sunlight)
Resilience	Excellent (Rebound)
Compression Set	Excellent
Abrasion Resistance	Excellent
Tear Resistance	Excellent
Solvent Resistance	Poor
Oil Resistance	Poor